 This luminaire contains built-in LED lamps.

The lamps cannot be changed in the luminaire

~~A~~
A+
~~A~~
~~B~~
~~C~~
~~D~~
~~E~~

} LED

smartwares® GWI-171-MG 874/2012

 Diese Leuchte enthält eingebaute LED-Lampen.

Die Lampen können in der Leuchte nicht ausgetauscht werden.

~~A~~
A+
~~A~~
~~B~~
~~C~~
~~D~~
~~E~~

} LED

smartwares® GWI-171-MG 874/2012

 Ce luminaire est composé des lampes à LED intégrées.

Les lampes de ce luminaire ne peuvent pas être changées.

~~A~~
A+
~~A~~
~~B~~
~~C~~
~~D~~
~~E~~

} LED

smartwares® GWI-171-MG 874/2012

 Deze armatuur bevat ingebouwde LED-Lampen.

In de armatuur kunnen de lampen niet worden vervangen.

~~A~~
A+
~~A~~
~~B~~
~~C~~
~~D~~
~~E~~

} LED

smartwares® GWI-171-MG 874/2012

220-240V~ 50Hz
7W

IP44 

CUSTOMER SERVICE	
NL: 0900-208888	Lokaal tarief
BE: 070-233031 (NL) Lokaal tarief	
: 0800-97570 (FR) Gratuit	
FR: 0825 560 650	15ct/min
DE: +49 (0) 1805 010762	14ct/Min. dt. Festnetz.
UK: +44 (0) 345 230 1231	Mobil max. 42ct/Min
ES: +34 938427589	
smartwares® Europe	Jules Verneweg 87 5015 BH Tilburg The Netherlands service.smartwares.eu



smartwares®



OUTDOOR
USE



STAINLESS STEEL +
COATING

Integrated LED wall light

NL Geïntegreerde LED wandlamp DE Integrierte LED-Wandleuchte
FR Luminaire d'entrée ES Luz de pared LED integrada IT Luce da parete a LED
integrati PT Luz de parede LED integr SE Integrerad LED väggampa
TR Kapi no plakalı entegre LED PL Kinkiet LED ze zintegrowany

GWI-171-MG - 10.048.03

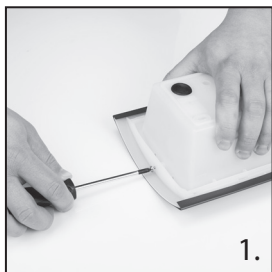

1.



2.

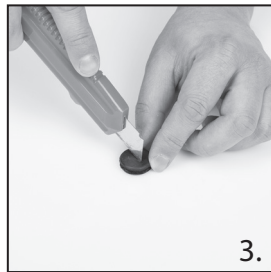

3.

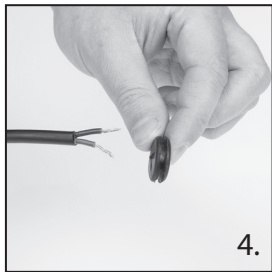

4.

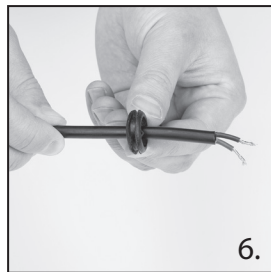

6.

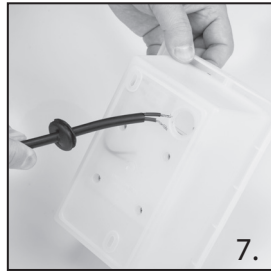

7.

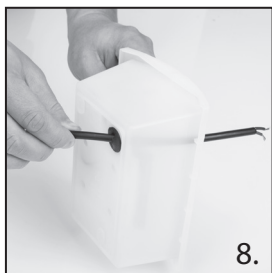

8.

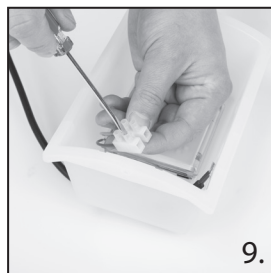

9.

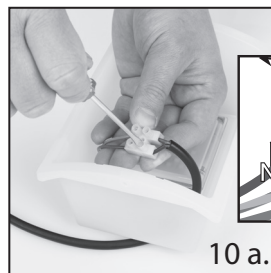

10 a.

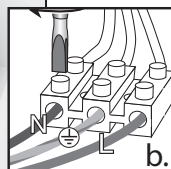

11.

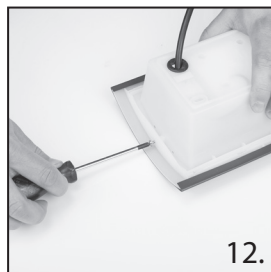

12.



OUTDOOR
USE



220-240V ~
50Hz



IP44

7

WATT
NOT REPLACEABLE



25.000
HOURS



NOT
DIMMABLE



ON / OFF
≥15.000x



Ra
>65



630
LUMEN



3000K
WARM WHITE

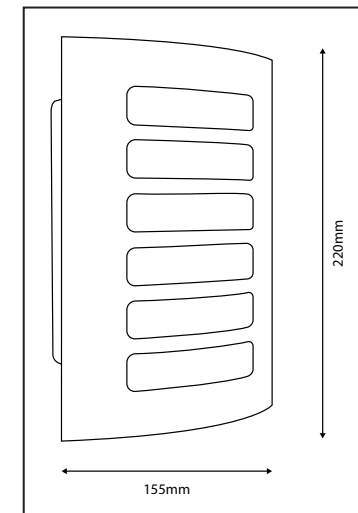

IP44



- GB** The fixture is splash-proof.
- NL** Het armatuur is spatwaterdicht.
- F** L'armature est étanche aux projections d'eau.
- D** Die Armatur ist spritzwasserdicht.
- N** Armaturet er beskyttet mot sprut.
- S** Armaturen är tät mot stänkvatten.
- DK** Armaturet er stænktæt.
- FIN** Valaisin on roiskevedenpitävä.
- PL** Urządzenie jest bрызgoszczelne.
- RUS** Осветительная арматура является брызгозащитенной.
- H** A szerelvény fröccsenésálló.
- RO** Corpul de iluminat este rezistent la stropire.
- SK** Zariadenie je chránené proti postriekaniu.
- HR** Svjetiljka je zaštićena protiv štrcanja vode.
- CZ** Zařízení je chráněno proti postřiku.
- SLO** Nosilec je odporen proti curkom.
- I** La lampada è protetta contro gli spruzzi d'acqua.
- P** A ferragem de conexão é a prova de salpicos.
- E** El montaje está protegido contra salpicaduras.
- GR** Η εφαρμογή είναι αδιάβροχη στα πσιλισματα.
- TR** Tertibat sýçramalara karbý dayanýklýdır.

- GB** Protection class 1: the fitting must be earthed.
- NL** Beschermklasse 1, het armatuur moet geaard worden.
- F** Classe de sécurité 1, l'armature doit être mise à la terre.
- D** Schutzklasse 1, die Armatur muss geerdet werden.
- N** Beskyttelsesklasse 1: armaturet må jordes.
- S** Skyddsklass 1, armaturen måste jordas.
- DK** Beskyttelsesklasse 1, armaturet skal have jordforbindelse.
- FIN** Suojausluokka 1, valaisin pitää maadoittaa.
- PL** Klasa zabezpieczenia 1: urządzenie musi być uziemione.
- RUS** Класс защиты 1: арматура должна быть заземлена.
- BG** Защита от клас 1: осветителното тяло трябва да е заземено.
- H** 1. védelmi osztály: a szerelvény földelhető.
- RO** Clasă 1 de protecție: corpul de iluminat trebuie împământat.
- SK** Trieda ochrany 1: zariadenie musí byť uzemnené.
- HR** Klasa zaštite 1: svjetiljka mora biti uzemljeno.
- CZ** Třída ochrany 1: zařízení musí být uzemněno.
- SLO** Zaščitni razred 1: nosilec senzorja je potrebno ozemljiti.
- I** Classe di protezione 1, la lampada deve avere la messa a terra.
- P** Classe 1 de protecção: a ferragem de conexão deve ser ligada à terra.
- E** Protección de Clase 1: el montaje debe estar conectado a tierra.
- GR** Προστατευτικό γυαλί 1: η εφαρμογή πρέπει να γειωθεί.
- TR** Emniyet türü 1: Tertibat topraklanmalıdır.