

LED Digital Bed-lighting Sensor Strips

Product Photo



LED Digital Bed-lighting Sensor Strips

Human motion capture and artificial intelligent control, will not work during the day, night lights up, back to bed lamp off



need it.

✧**Easy setup No tools required**

Installed in few minutes with a few easy steps.
Ready to attach with 3M adhesive tape.

✧**Low energy**

LED consumes up to 7.5W to Produce the same light as up to 25W incandescent bulb.

room.

✧**Long life time**

LED last up 10 years based on average activation of 1 hour per day.

✧**Thoughtful lighting**

A warm soft glow of light,where you need it, when you need it, with no disturbing glare to wake others and no fumbling to find the light switch in the dark.

Temperature Characteristics

Temperature	Humidity
Operating: -20~+40°C	Operating: 10%-80%
Storage: -40~+85°C	Storage: 10%-80%

Electrical Characteristics

Input Voltage : DC12V

Technical Parameters

Model No.	Product Application Scenarios	Accessories
CL-CDA-1	Single Bed / Children's Bed	1.12V Power Adapter 1pcs 2.Body Induction and light induction sensor 1pc 3.1.2m LED strip 1pc
CL-CDA-2	Double Bed	1.12V Power Adapter 1pcs 2.Body Induction and light induction sensor 2pc 3.1.2m LED strip 2pcs 4. deconcentrator 1pc

Single Bed :CL-CDA-1



INSTALLATION INSTRUCTIONS

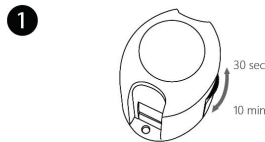

1 Timing adjustment

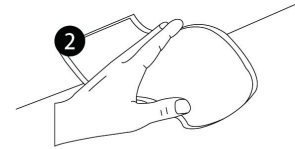

2 Clean Surface
Before installation, please completely clean and wipe the surface which need to be installed. See Figure 2

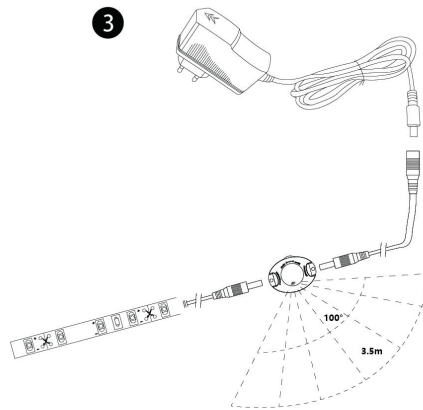

Option
It can be cut according to the length which you need

3 Connect components
Opening and spreading the LED strip, connects to the sensor and adapter, See Figure 3

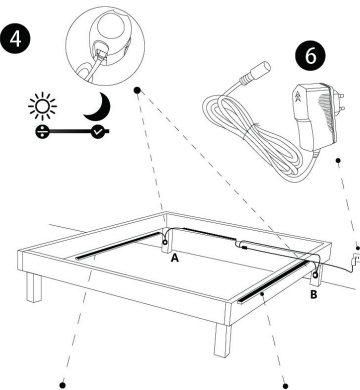

4 Choose the Sensor installation position

Choose a best position where the Sensor will be installed can directly feel body motion movement or the ambient light. advice A or B position, see figure 4

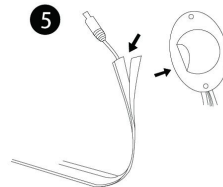

5 Installation under the bed
Place the connected components under the bed. To ensure that the adapter is plugged into a power socket, otherwise, add an extra power socket. Before installing the sensor and strips, please tear up 3M tape adhesive protection layer. see figure 5

6 Power supply
Please plug the adapter into the socket, see figure 6, and the sensor will be automatically timing time about 30 seconds after power on.

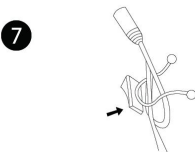

7 Installation suggestions
After finishing the installation, please use the right clips to fix the connection wires. see figure 7

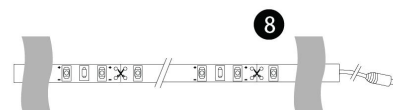

8 Fixed strips
see figure 8, used for fixing the both ends of strips, to prevent the strip from falling.

Double Bed: CL-CDA-2

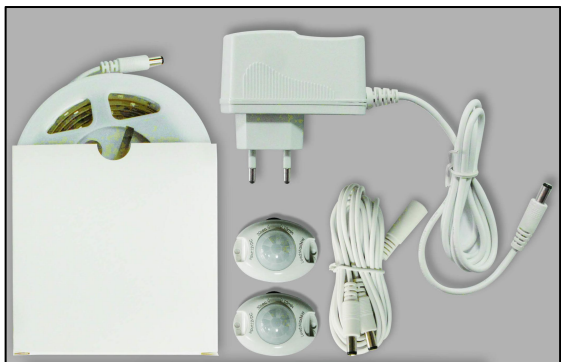

INSTALLATION INSTRUCTIONS

1

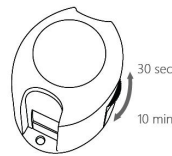

1 Timing adjustment

The sensor timing time is 30 seconds for the factory settings, can be easily installed at any time. If you need longer lighting time, the sensor timer can be set up to 10 minutes, just adjust the side of the sensor's button to 10 minutes. See Figure 1

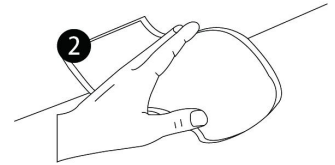

2 Clean Surface

Before installation, please completely clean and wipe the surface which need to be installed. See Figure 2



Option

it can be cut according to the length which you need

3

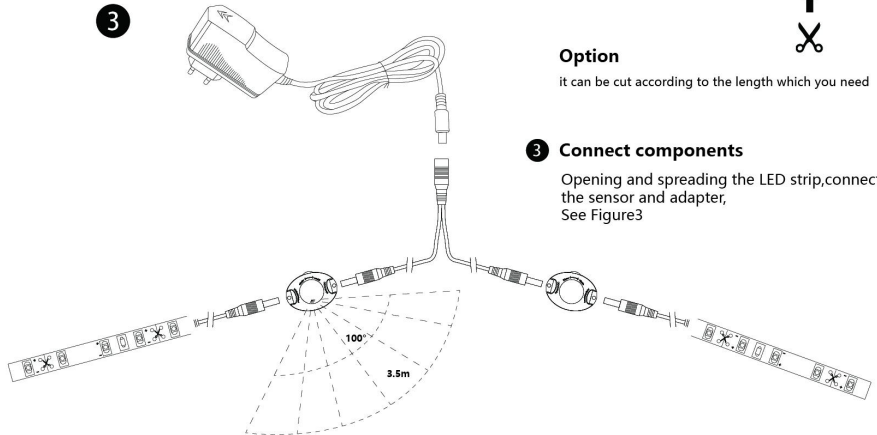

3 Connect components

Opening and spreading the LED strip, connects to the sensor and adapter, See Figure 3

4

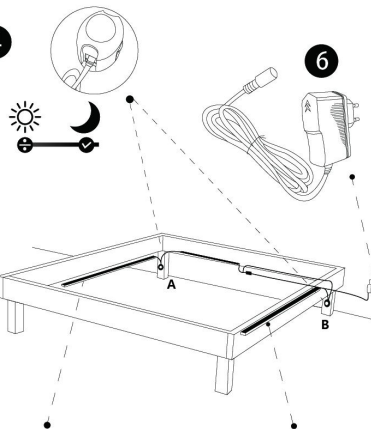

4 Choose the Sensor installation position

Choose a best position where the Sensor will be installed can directly feel body motion movement or the ambient light. advice A or B position, see figure 4

5

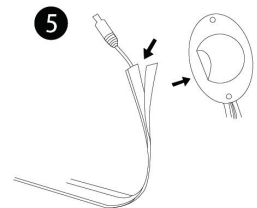

5 Installation under the bed

Place the connected components under the bed. To ensure that the adapter is plugged into a power socket. Otherwise, add an extra power socket. Before installing the sensor and strips, please tear up 3M tape adhesive protection layer. see figure 5

6 Power supply

Please plug the adapter into the socket, see figure 6. and the sensor will be automatically timing time about 30 seconds after power on.

7

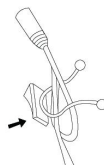

7 Installation suggestions

After finishing the installation, please use the right clips to fix the connection wires. see figure 7

8

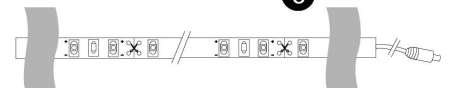

8 Fixed strips

see figure 8, used for fixing the both ends of strips, to prevent the strip from falling.

Blister kits accessories:

Items name	applications	List of accessories						
		1.2M strips	12Vadapter	Branch connection	Sensor switch	The wire fixing seat 1	The wire fixing seat 2	screw
CL-CDA-1	Single Bed	1	1	0	1	1	1	2
CL-CDA-2	Double Bed	2	1	1	2	2	2	4

Packaging Guide

Model No.	PCS/CTN	Carton Size 尺寸/CM
CL-CDA-1	24 kits/ CTN	41*41*22CM
CL-CDA-2	16 kits /CTN	41*41*22CM

