

RLX-1201 Infrared Sensor Instruction

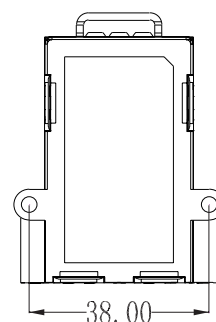

Unit:mm

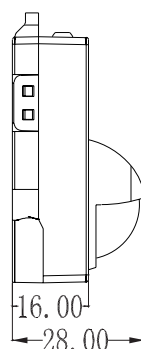
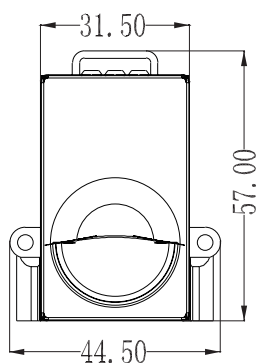

Summary

The product is a new saving-energy switch adopting the good sensitivity detector, integrated circuit and SMT. It gathers automatic, convenient, safe, saving-energy and practical functions. The wide detection field is made up of up and down, left and right service field. It works by receiving human motion infrared rays. When one enters the detection fields, it can start the load at once and identify day and night automatically; it can be used with various types of lamps and lanterns .

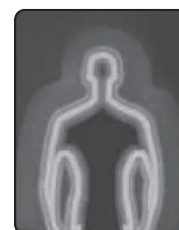

IP:44

Characters

- It can identify day and night automatically. And the working light can be chosen freely and make it work at night and not work in the day time.
- Illuminated time can be adjusted according to the customer's desire.
- Mini shell (57mm*44.5mm*28mm)
- Sense LED: when it detect sensing signal, the LED flash.

Specifications

Power source: 220-240V/AC
 Power frequency: 50Hz
 Rated load: 50W Max.
 Detection range: 9m Max.
 Time setting: Min: <5sec
 Max: 8min±1min(adjustable)
 Detection angle: 120°

Light-control: <10~2000LUX (adjustable)
 Working humidity: <93%RH
 Working temperature: -25~+45℃
 Power consumption: <0.5W
 Installation height: 0.7~2m
 Black ☐ White ☐

Sensor information

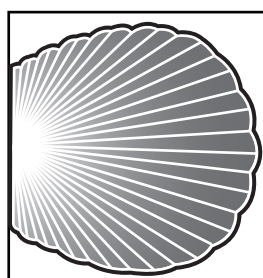
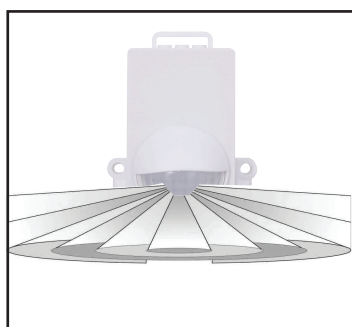

9m Max
Correct moving orientation

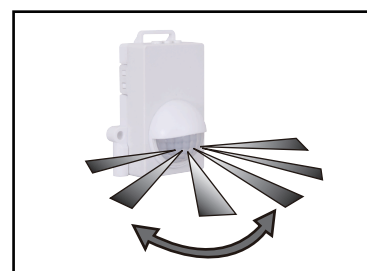

120°
Detection Angle

Connection-wire diagram

Connect the power and the load wire with the sensor according to connection-wire diagram;

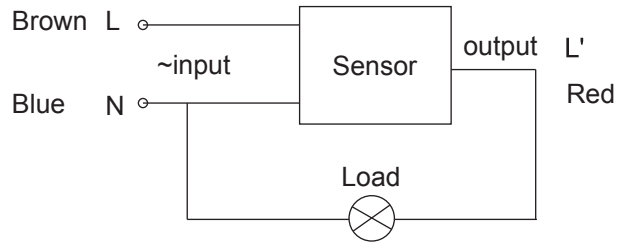

Test

- After installation, before switching on power turn the time anti-clockwise to min;
- Switch on power, after 30sec the sensor enter stable working state;
- After the load turn off, sense it, the load should turn on, and under the condition that no continual sensing signal, the load should turn off within 5sec;
- When the light-control knob anti-clockwise set to the min, if you test the unit in the daytime, sense it, the load should not work. Cover the detection window with opaque object (simulate night light) and sense it, the load should turn on;
- If all are normal, according to your require you can turn the time knob to set the lighting time and turn the light-control knob to select working light.

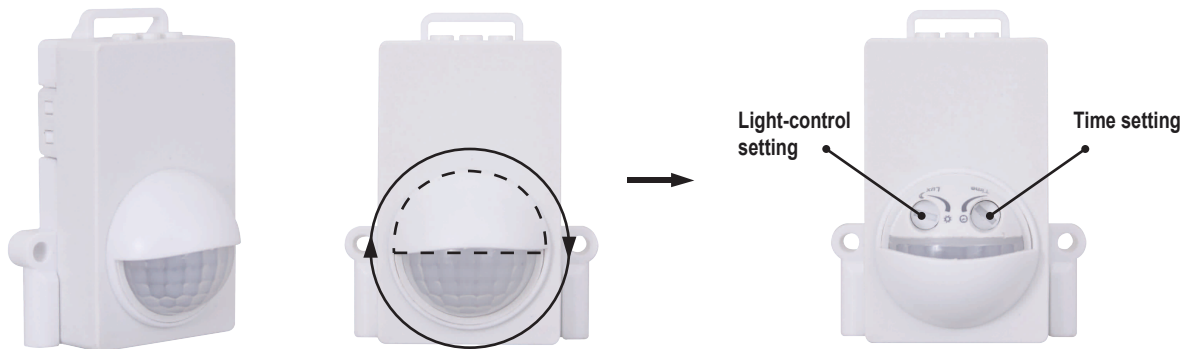

Note: please don't adjust the two functional buttons to excess. That is because the two functional buttons were connected to the components directly, there is a small stopper in each of the two components, when you adjust the buttons from start to end, the excessive turn will damage the stopper, and lead to the 360° non-stop turn around. The adjust range limit is 270°, please do pay attention to this.

The factory intercalation: Light-control is max, Time setting is min.

Notes

- Electrician or experienced human can install it.
- The unrest objects can't be regarded the installation basis-face.
- In front of the detection window there should be no hinder or unrest objects effecting detection.
- Avoid installing it near air temperature alteration zones for example: air condition, central heating, etc.
- Please don't open the case for your safety if you find the hitch after installation.

Remark

1. Keep the sensor face to the area where human usually move.
2. Keep the sensor face to the position of the ambient light in order to get much more exact illuminance setting.
3. If detect the signal again within the time-delay, the time-delay will be over lied.



Some problem and solved way

- The load don't work:
 - a: Check the power and the load.
 - b: If the load is good.
 - c: Please check if the working light correspond to the ambient light.
- The sensitivity is poor:
 - a: Please check if in front of the detection window there is hinder that effect to receive the signals.
 - b: Please check if the ambient temperature is too high.
 - c: Please check if the signals source is in the detection fields.
 - d: If the moving orientation is right.
- The sensor can't shut automatically the load:
 - a: If there is continual signal in the detection fields.
 - b: If the time delay is set to the longest.
 - c: If the power correspond to the instruction.
 - d: If the air temperature change near the sensor, for example air condition or central heating etc.



Warning!

- Please confirm with professional installation.
- Please cut off power supply before installation and removal operations.
- Make sure that you have cut off the power for safety purposes.
- Improper operation caused losses, the manufacturer does not undertake any responsibility.

We are committed to promoting the product quality and reliability, however, all the electronic components have certain probabilities to become ineffective, which will cause some troubles. When designing, we have paid attention to redundant designs and adopted safety quota to avoid any troubles.

This instruction, without our permission, should not be copied for any other purposes.