

Satellite CL1 White

90759

1、 Before installation disconnect the mains supply. Take out the plate from the fixture and position on the wall.(see item in drawing 1).

1

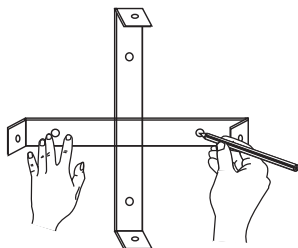

4

4、 Connect the fixture to the mains supply.

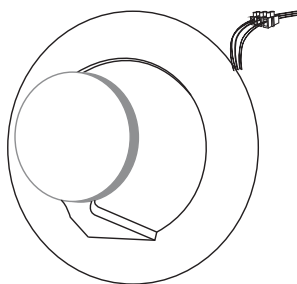

2、 Drill holes and insert wall plugs.

2

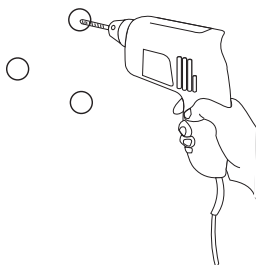

3、 Fix plate to wall with screws(supplied)and make sure plate is level .

3

