



WWW.QAZQA.COM

## **Motion V CL 14W LED PIR MODEL: 90498**

We are delighted that you have purchased this MICROWAVE lamp. This lamp is suitable for indoor use only. Please read this instruction manual before installation and retain for future reference.

**IMPORTANT:** Never modify the unit, there are no user serviceable parts inside. Not suitable for use with dimmer switches. Install in accordance with IEC Wiring Regulations.

**THE LIGHT SHOULD BE INSTALLED BY A QUALIFIED ELECTRICIAN.**

### **HAVE YOUR LIGHT WORK WELL**

To achieve the best results, take the following points into account:

1. The sensor will reach the optimum performance when mounted at a height of more than 2.5 meters
2. Avoid pointing at or positioning close to heat sources such as heaters or heat extraction units otherwise it may falsely trigger off the light.
3. Avoid pointing at bright lights as the PIR sensor will not function when you set Lux control level to dark (D position).
4. Avoid mounting at a strong electromagnetic disturbance, i.e. near electrical motor or fluorescent lamp ballast.

### **INSTALLATION(See Figure )**

Before commencing any electrical work, ensure the mains supply cables have been isolated by switching off and removing the relevant fuse.

1. Open the lamp cover
2. Unscrew the Terminal Block Cover Screw then remove the Terminal Block Cover
3. Connecting the Power Cable (H05RN-F 3G 1mm<sup>2</sup>, not included) to the Terminal Block, see the relative symbol. Ensure the cable must pass through the Cable Gasket.
4. Refit the Terminal Block Cover
5. Use the Main body to mark the position of screw holes onto mounting surface. Drill the wall to depth of about 30 mm and fit the plastic plugs, and then fix the Cover to the mounting surface with rightly screws. Be careful to avoid drilling or screwing into concealed electrical wiring.
6. Refit the lamp cover

**QAZQA**



WWW.QAZQA.COM

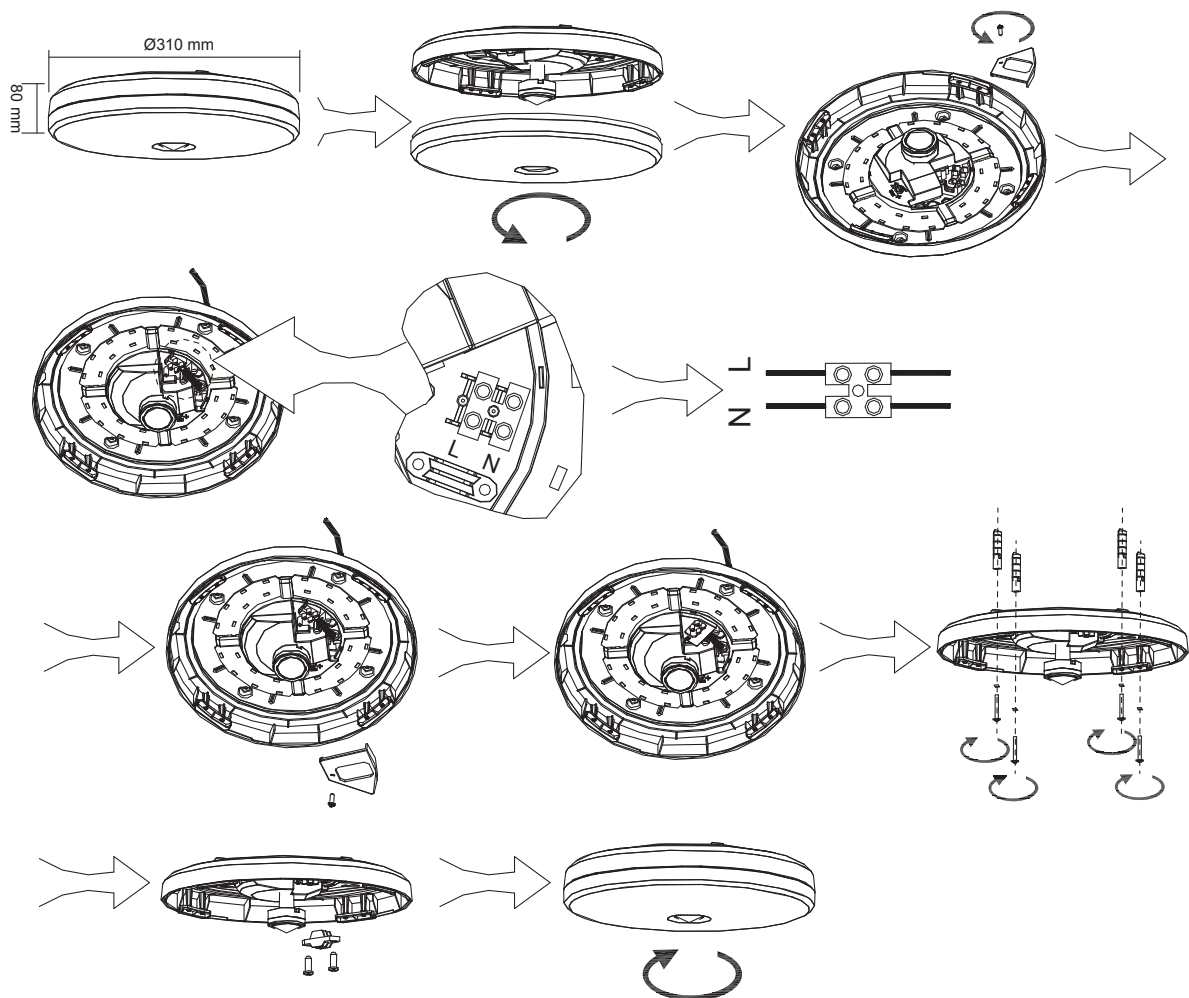

### ADJUSTING THE DURATION TIME:

The duration time is “the length of time that light switches ‘on’ after activation. The duration time can be adjusted from  $10\pm5s$  to  $4\pm1$  min. by the knob. Note: Once the light has been triggered by the PIR sensor any subsequent detection will start the timed period again from the beginning.

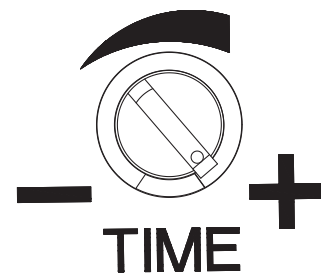

### IMPORTANT:

- 1) Never attempt to remove the lens cover as this will damage the sensor.
- 2) The Light will become hot when it on, please let it cool before replacement of bulb or touch.
- 3) The light is IP44 weather proof and suitable for indoor use only.

### TECHNICAL DETAILS:

Voltage:	220 V-240VAC~ 50 Hz
Wattage:	28x0.5W LED
Detection range:	360° and Max. 5 meters radius
Delay time:	$10\pm5s$ to $4\pm1$ min
Lux control level:	<10LUX
IP :	44

**QAZQA**