

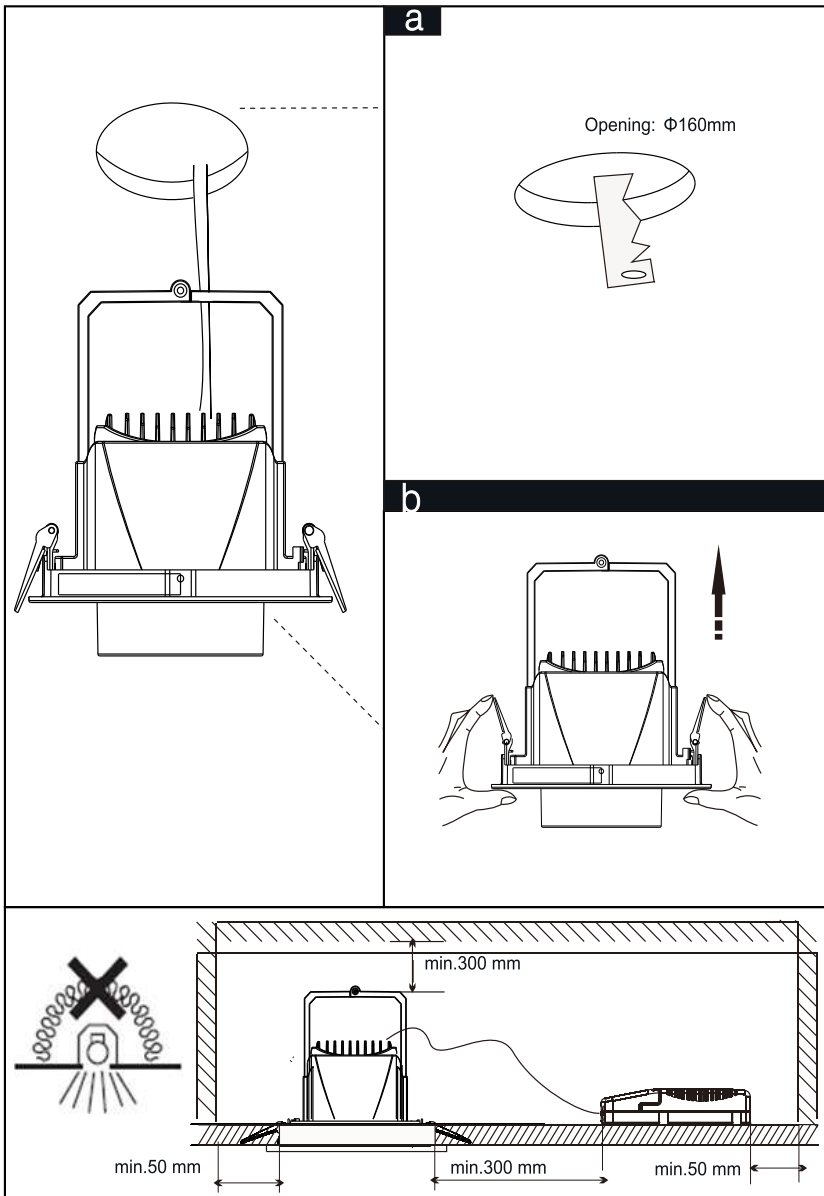

WWW.QAZQA.COM

IP  
20

220-240V~  
50Hz



IP20

QAZQA



WWW.QAZQA.COM

Ruler DL  
89986/

## Instruction

1. Input 220-240V~50Hz, please refer to the label on the lamp.
2. Do not touch the lamp directly.
3. The lamp should not be used for any other purpose.
4. If the lamp is damaged, please do not use it.
5. Please do not touch the lamp directly.
6. Any LED lamp should be used.
7. Under no circumstances should the lamp be used for insulation, etc.
8. If the external temperature is too high, please do not use the lamp.
9. The lamp should be used in a dry place.
10. The lamp should be used in a dry place.
11. To avoid fire, please do not use the lamp in a flammable environment.

This lamp is  
Safety Norm

White

90524

**S:**



240V, 50Hz, for rated wattages,

refer to the label on the product.

replace the bulb or any other part when

is switched on.

must be fitted with at least 0.8mm space between

cts.

tic shield is damaged, please contact Lamp and Light.

not install this lamp into a damaged or deformed ceiling.

modules are non-replaceable.

circumstances, can the lamp be covered with heat

gaskets or similar materials.

ternal cable of the lamp is damaged, it must be replaced

manufacturer, or a qualified electrician to avoid any electrical

should only be used with its protective plastic shield in

o is suitable for indoor use only.

a potential lamp/bulb failure, it is recommended that the

switched off at least once a week.

s produced according to the strict regulations of the  
n EN – 60 598

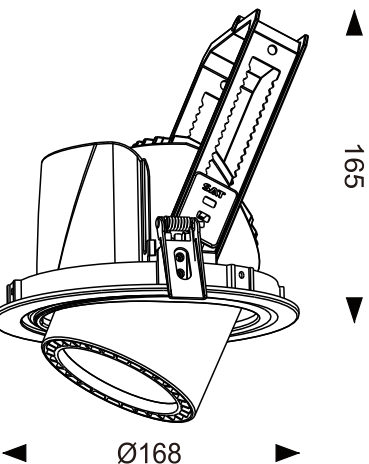

**QAZQA**