

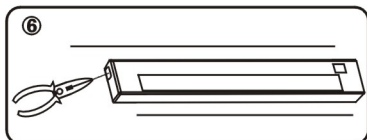

WWW.QAZQA.COM

INSTRUCTIONS

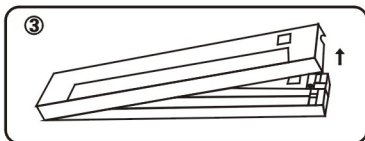
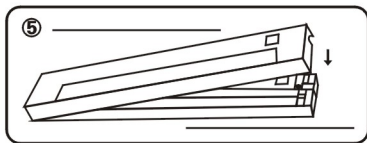
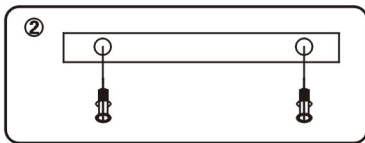
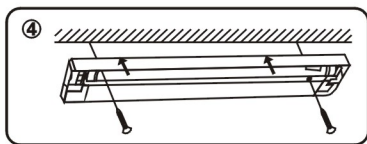
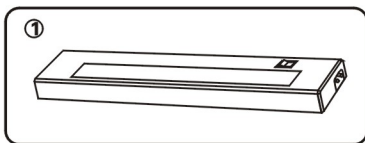

Replacing the lamp

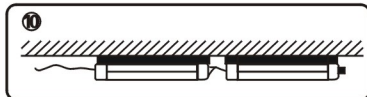
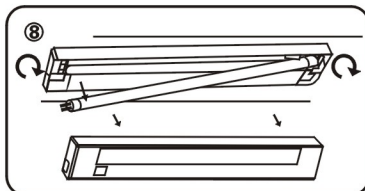
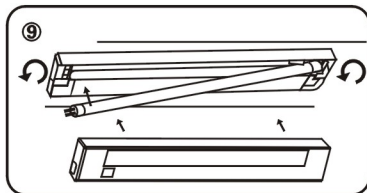
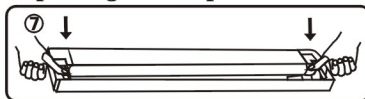

Max. 10pcs interconnected



PRODUCT DIMENSION

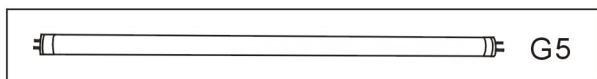
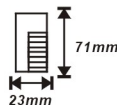

89443

QAZQA



WWW.QAZQA.COM

INSTRUCTIONS



Please operate this product strictly according to the instructions. Do not modify or tamper with this product in any way, this product is for indoor use only.

Warning:

Please use between AC 220-240V 50Hz.

This product is suitable for any stable surface and can also be used on wooden surfaces.

In order to avoid the lamp being damaged, please do not use this product in a high temperature environment or humid environment.

This lamp is not designed to be used with a dimmer.

Please ensure only a qualified electrician installs this product to avoid danger.

If a part needs replacing or the product starts to work abnormally, please use a qualified electrician to maintain or replace components within the lamp.

Please switch off and remove the lamp from the power supply, before replacing the bulb.

89443

QAZQA