



WWW.QAZQA.COM

Motion CL III Satin MODEL: 89440

INTRODUCTION

The Light incorporates a PIR (Passive Infra Red) sensing device which continuously scans a preset operating zone and immediately switches the light on when it detects movement in that area. This means that whenever movement is detected within the range of the sensor the light will switch on automatically to illuminate pathways, steps, patios, porches, or whatever area you have selected to light for reasons of safety, convenience or security.

While there is movement within range of the unit the light will remain on.

HAVE YOUR LIGHT WORK WELL

To achieve the best results, take the following points into account:

1. The sensor will reach the optimum performance when mounted at a height of more than 2.5 meters (see Figure 1)
2. Avoid pointing at or positioning close to heat sources such as heaters or heat extraction units otherwise it may falsely trigger off the light.
3. Avoid pointing at bright lights as the PIR sensor will not function when you set Lux control level to dark (☾ position).
4. Avoid mounting at a strong electromagnetic disturbance, i.e. near electrical motor or fluorescent lamp ballast.

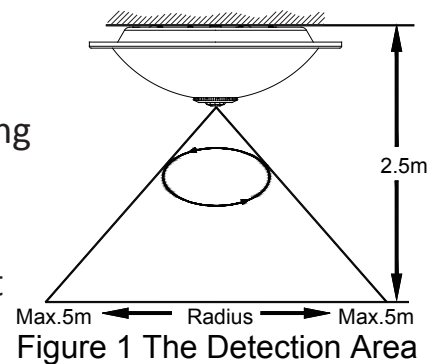

INSTALLATION

Before commencing any electrical work, ensure the mains supply cables have been isolated by switching off and removing the relevant fuse. (See Figure 2)

INSTRUCTION FOR MANUAL MODE:

There are two preset lighting modes for the lamp:

- 1) Sensor mode: Light standby in night. When people motion is detected, the lamp light on for a preset time of 1 or 3 min., please refer to the instruction above. In sensor mode, the light will not turn on in day time.
- 2) Light on mode: Sensor does not work and the light turns on for 8 hours and turn off automatically either in day time or in night.

When power on, to shift the mode from one to another, turn the main power switch "OFF"- "ON"- "OFF"- "ON" rapidly in 2 seconds.

QAZQA



WWW.QAZQA.COM

When successfully shift to “sensor model”, the lamp will flash quickly for 3 times. When successfully shift to “sensor model”, the lamp will flash slowly for 3 times.

After switch off the main power or after the 8-hour working in “Light on mode”, the light will automatically shifts to “sensor mode” when the light power on again. Then the lamp will flash quickly for 3 times.

IMPORTANT:

- 1) Never attempt to remove the lens cover as this will damage the sensor.
- 2) The Light will become hot when it on, please let it cool before replacement of bulb or touch.
- 3) The light is IP20 weather proof and suitable for indoor use only.

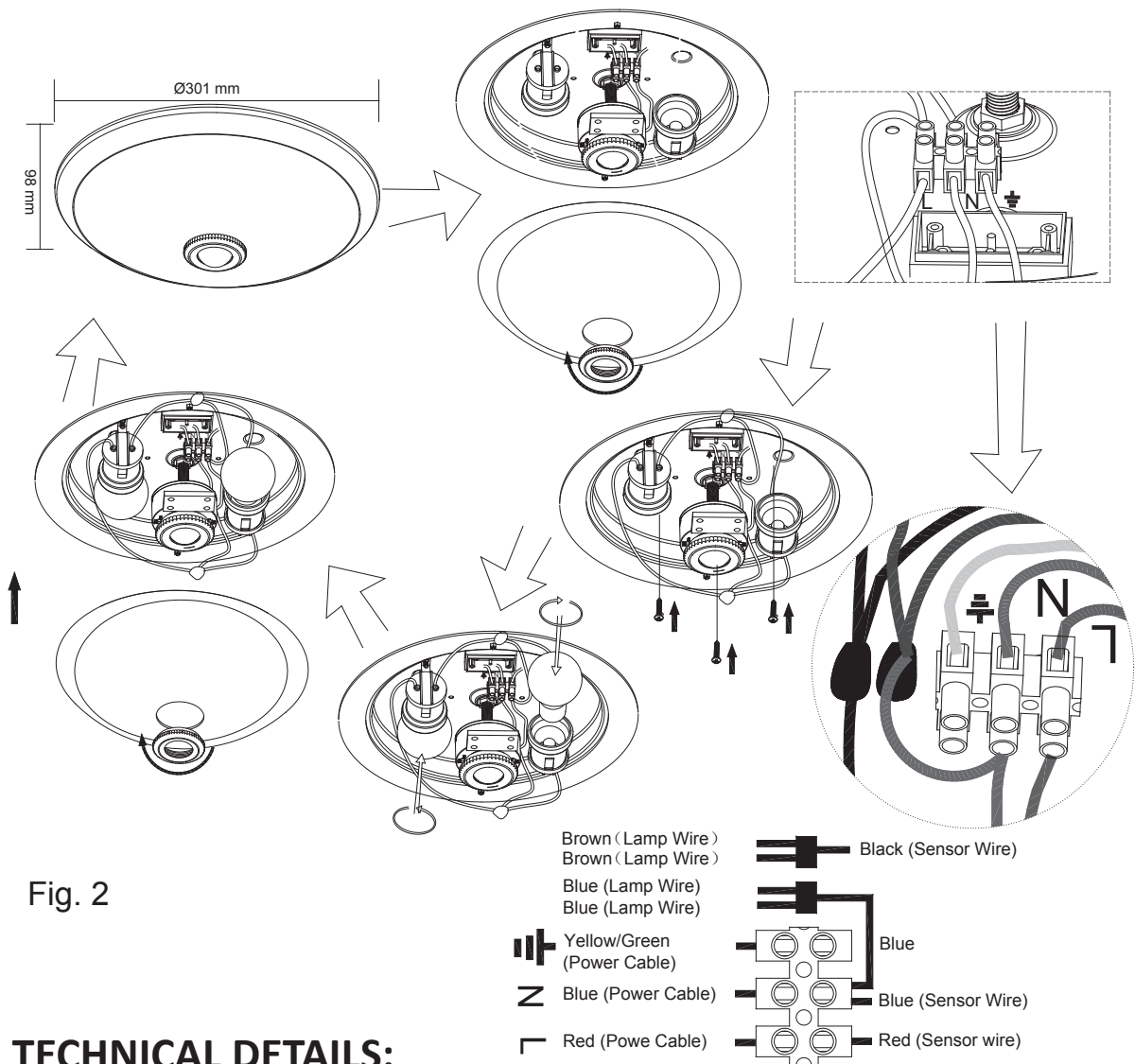

Fig. 2

TECHNICAL DETAILS:

- Voltage: 230 V~ 50 Hz
- Wattage: Max. 2x 25Watt/230V~ incandescent bulb (Resistive-Load)
- Detection range: 360° and Max. 5 meters radius (see Figure 1)
- Delay time: 1 min. or 3 min
- Lux control level: Daylight to Night adjustable

