



WWW.QAZQA.COM

# 89307

## INSTRUCTION

### Technical Parameters

- ◆ Working temperature: -20-60 °C
- ◆ Supply voltage: DC12V
- ◆ Output: 3 channels
- ◆ Connecting mode: common anode

### External Dimension

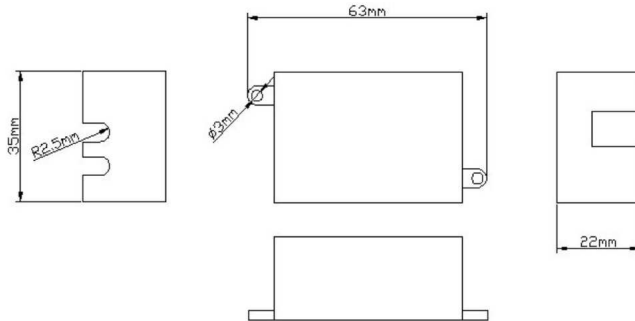

### Connection with Strips:

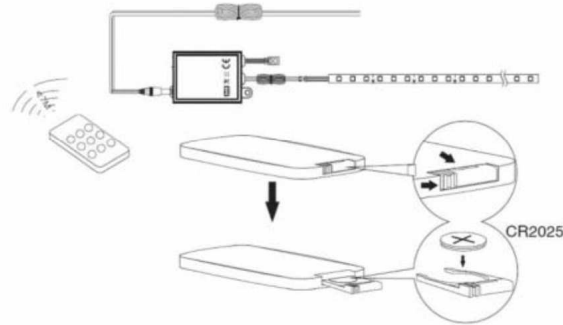

Note: Pls Be Sure To Connect The Controller And The Strips As Below,

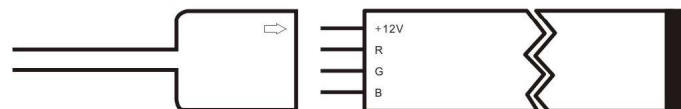

### Direction for use

The key-press functions are shown in the table below:

# QAZQA



WWW.QAZQA.COM

# 89307

## INSTRUCTION

- : In any state, you could turn on/off the controller at any times
- : Three-color jumpy changing;
- : Three-color strobing changing;
- : Three-color gradual changing;
- : Three-color fade in then fade out;
- : Adjusting brightness button; the brightness will increase one level when you press the button one time
- : Adjusting brightness button; the brightness will decrease one level when you press the button one time

**Other buttons:** Display the corresponding color of the button on the remote control panel

### Attentions:

1. Supply voltage of this product is DC12V~24V; never connect to other sizes of voltages;
2. The IR sensor need to be in sight so can controlled by the remote.
3. Never connect two wires directly in case of short circuit;
4. Load wires should be connected correctly according to the connecting diagram offers;
5. Don't peel off the label on the controller in case any indication of information will be missed;
6. Warranty of this product is two year. In this period, we guarantee replacement or repairing with no charge, but exclude the artificial situation of damaged or overload working.

### Typical Applications

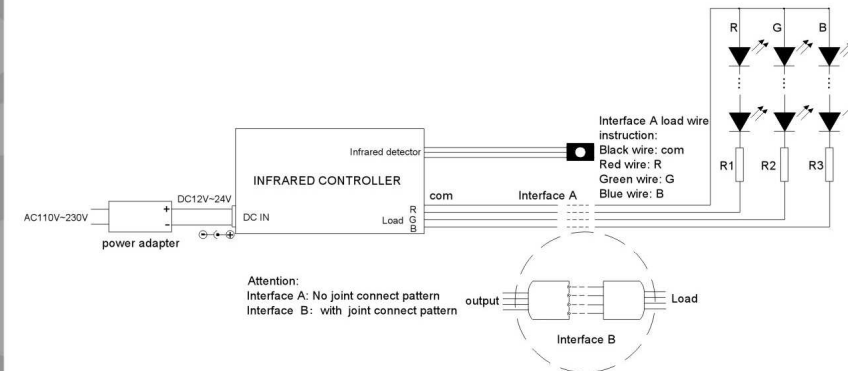

# QAZQA