



**.Model:89177**

**.Type:Halogen Light**

**.Illuminant:MR16 halogen bulb**

**.Technical Specifications:**

**.Voltage:12V 50Hz/60Hz**

**.Power:MR16 bulb Max.50W**

**.IP Grade:IP20**

**.Safe Grade:Class III**

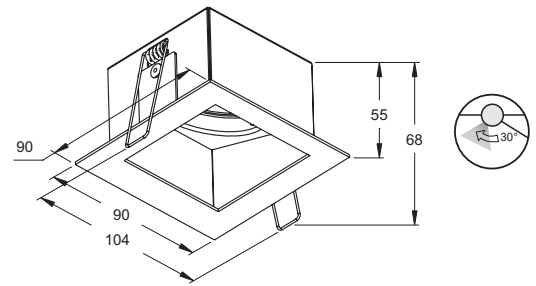

**Installation:**

.Switch off the power before installation;

.Cut hole 78x72mm;

.Connect the wire according to the drawing;

.Turn the springs on both back sides up a certain angle by hand, which will make the lamp body and spring enter into the setting hole. Then adjusting the lighting fixture to a right position after it is fixed successfully;

.Install the bulb into the lampholder, fix the ring.

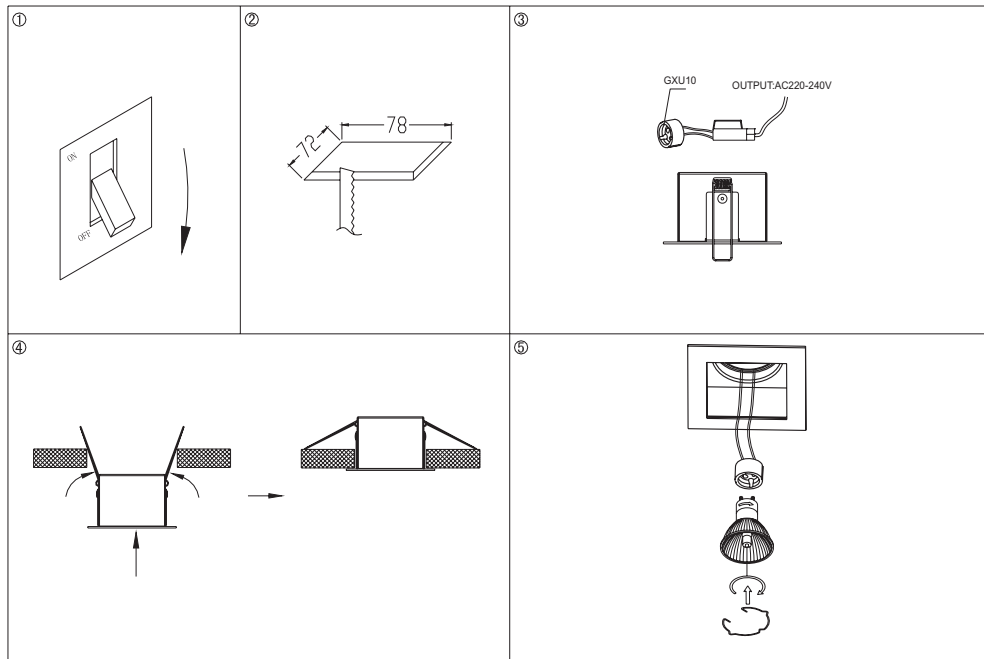

**Recommendation for safety:**

.Install the lighting fixture by professional only;

.Make sure power is off before installing;

.Do not touch the bulb when it lights on;

.Always turn off the power for few minutes before handling or replacing the bulb;

.Allow distance of at least 0.5m between the lamp and light surface;

.Use only dry cloth to clean the bulb, do not use cleanser or chemical cleaning products;

.The actual use power should not override the rated power.