

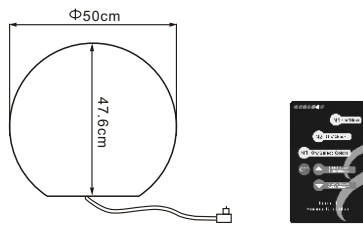

Please note the information contained in this manual and follow the instructions provided; please save this manual for future reference.

Instructions for use:

1. The LED's for this product are housed in the bottom of the plastic cover
2. The lighting functions of the lamp are controlled by the remote control
3. Plug the lamp into your power supply, you will then be able to control the lamp by using the remote. All the functions of the remote control are printed on it.



N1 On/slow: The LED's change colour slowly

N2 On/quick: The LED's change colour quickly

N3 On/select colours: Press this button on the remote to choose a single colour to be displayed

OFF + N1&N2 Speed (When using the N1 or N2 setting, press this button to increase the speed of the colour changes)
Pressing N3 will increase the brightness when N3 is being used

OFF - N1&N2 Speed (When using the N1 or N2 setting, press this button to decrease the speed of the colour changes)
Pressing N3 will decrease the brightness when N3 is being used

Warning:

1. Do not put this product near any flammable liquids or explosive products
2. Do not open the product without a qualified electrician present
3. Keep the plastic cover clean & tidy and clear, to ensure you get the best light from your product
4. If the remote function is not working correctly, please check the batteries in the remote first
5. This product can be used both outdoors and indoors and is at the IP44 electrical standard
6. The flex cable supplied with this product cannot be replaced; if the cable is damaged, the product should be destroyed.