

INSTRUCTION MANUAL

These instructions are for your safety. Please read through them thoroughly prior to installation and retain them for future reference.

Warnings

- This product is Class I and must be earthed.
- It is recommended that this fitting is installed by a qualified electrician.
- This fitting should be fitted in accordance with IEE Regulations and the Building Regulations.
- For your safety, switch off at the mains supply before installing or maintaining this fitting. Ensure other persons cannot restore the electricity supply without your acknowledgement.
- If you are in any doubt, please consult a qualified electrician.
- If replacing an existing fitting, make a note of the connections.
- Always use the correct type and wattage bulb. Never exceed the wattage stated.
- When changing a bulb, always switch off at the mains and allow the old bulb to cool down before handling. Dispose of used bulbs carefully.
- The bulb and surrounding parts can become extremely hot during use.
- Cable Type - The correct cable must be used for wiring this fitting. We suggest that you use H05RN-F specification cable (not supplied) which is an outdoor grade, rubber sheathed cable. Running it inside a plastic conduit (not supplied) should further protect it. Alternatively, if the cable is to be in an area where it could become damaged, you should use special armoured cable. This type of cable has a sheath that is strengthened to protect against damage from objects such as garden tools, lawnmowers etc. The cable must have a minimum cross sectional area of 1.0mm² and wherever possible, cables should be run horizontally. Bury the cable minimum of 50cm.
- A light fitting should be connected to a lighting circuit protected by a 5-amp fuse, (or 6-amp residual current device). If a light fitting is to be connected to a ring main, a fused connection unit fitted with a 3-amp fuse should be installed. This product is only suitable for connection to AC 220-240V / 50Hz supply.
- We always recommend the use of an approved RCD unit.
- Replace any cracked/damaged diffuser immediately-do not use if they are damaged.
- The fitting is suitable to be installed in restricted accessible areas (e.g. pedestrians and pedal cycles only).
- The product has a rated maximum surface temperature of 100 °C.

Instructions

1. Ensure the house electricity supply is switched off at the fuse board.
2. If removing an existing fitting, note down all wiring connections.
3. Dig a hole 179mm wide and 450mm deep to accommodate the ground tube. Line the bottom with gravel to allow for drainage and leveling of the fitting.
4. Lower the ground tube into the hole and locate the mains supply in the cutout allowing enough length to connect into the terminal block. Ensure the ground tube is in contact with the surrounding ground and fill the space between the ground tube and the side of the hole flush with concrete.
5. Unscrew the gland nut to allow the mains supply cable to feed through. Feed the mains cable through the gland nut allowing enough cable to connect to the terminal block. Tighten the gland nut.
6. Connect the mains supply to the terminal block, using the following colour code for the wiring:
Connect the Brown (Live) wire to the corresponding terminal on the terminal block marked L.
Connect the Green/Yellow (Earth) from the mains supply to the Earth terminal marked E or .
Connect the Blue (Neutral) wire to the corresponding terminal on the terminal block marked N.
7. Fasten the casing onto the ground tube and tighten the fixing screws.





WWW.QAZQA.COM

8. Lead the reflector carefully over the lampholder, and press it over the lampholder. Assure that the reflector is located and fastened properly.
9. Fit the recommended lamp type: 40W ES GLS or 23W CFL, E27. Replacement lamp should be of the same type, voltage and wattage.
* Always switch off the electricity supply and allow to cool for 10 minutes before changing the lamp.
10. Re-assemble the fitting ensuring the sealing ring is properly seated against the glass diffuser to provide a waterproof seal.
Safety glass is certificated for max weight 2000KG.
11. Switch on the electricity supply at the fuse board.

Specifications

Product type: 44965

Rated voltage: AC 220-240V, 50Hz

Source of light: Max 40W GLS ES or Max 23W CFL, E27

Degree of protection: IP67 & IP65

Protection class: I

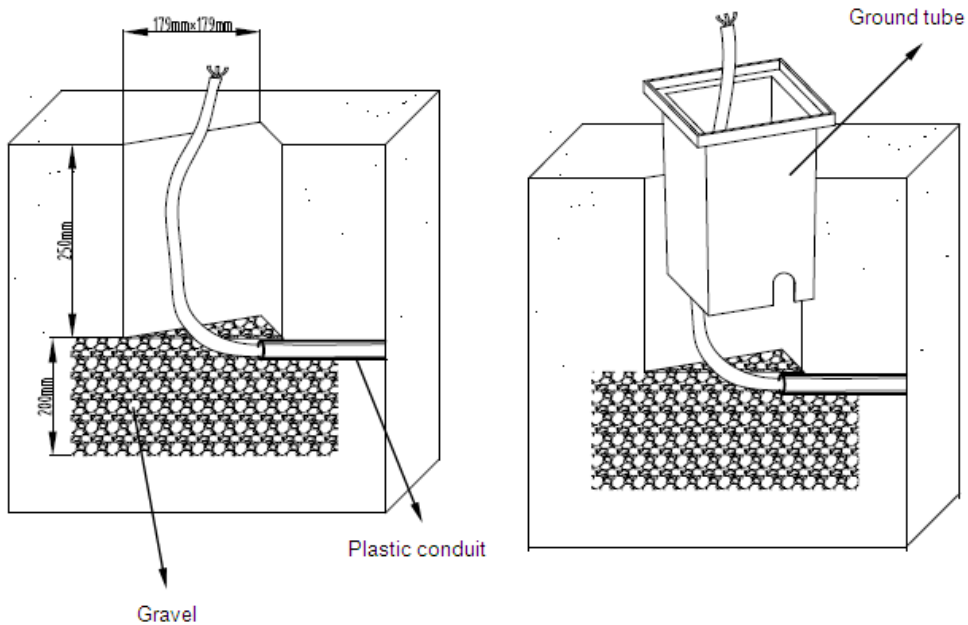

1

2

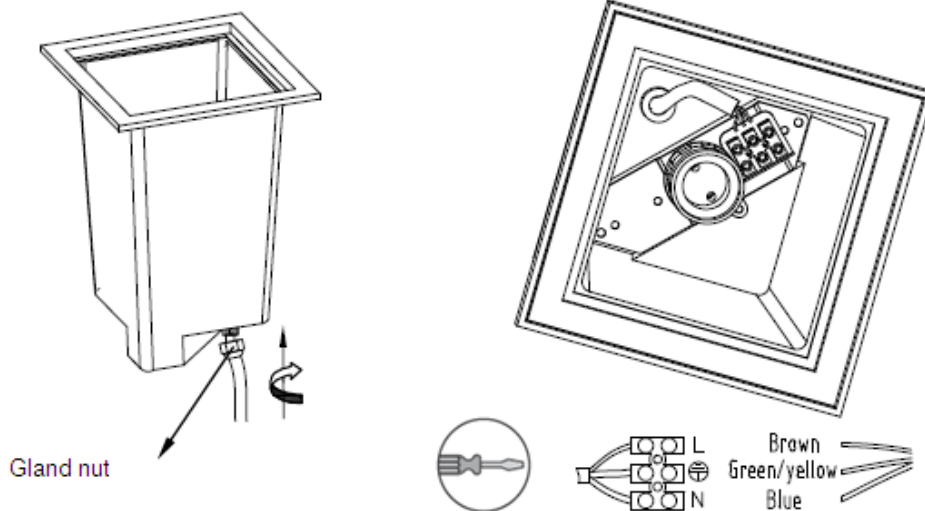

3

4



WWW.QAZQA.COM

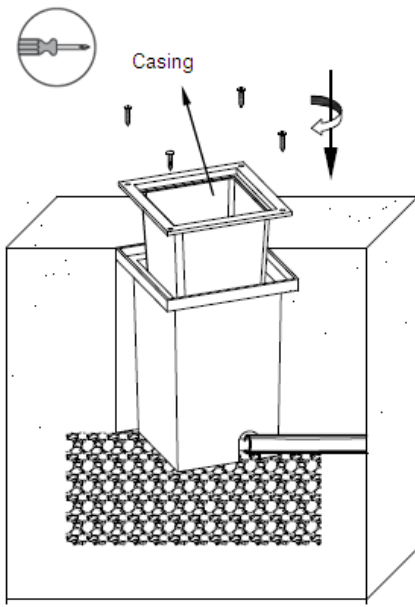

5

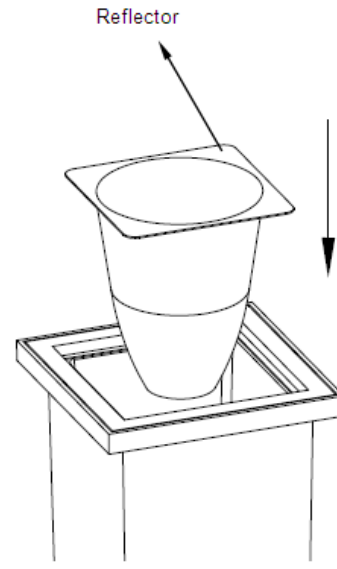

6

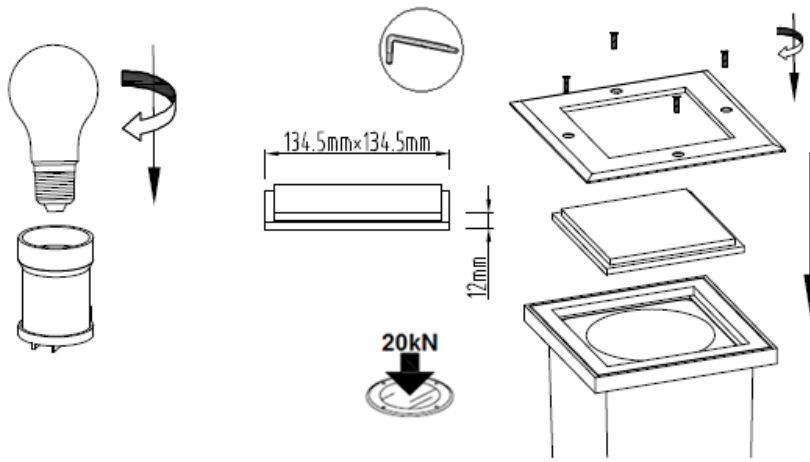

7

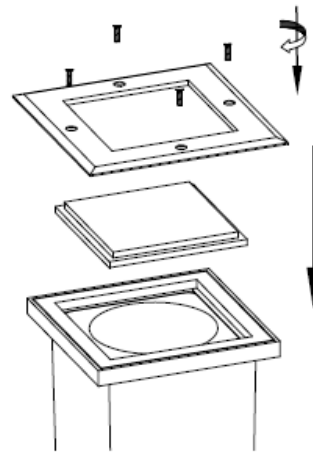

8

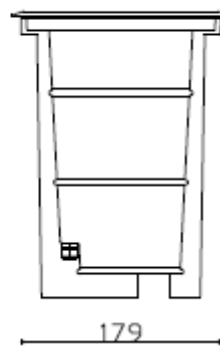
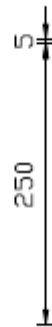
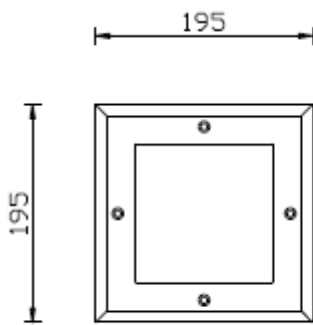

44965

QAZQA