

INSTRUCTION MANUAL



220-240V~
50Hz



Arya Q CL LED 120 cm Dimmable Remote
103472

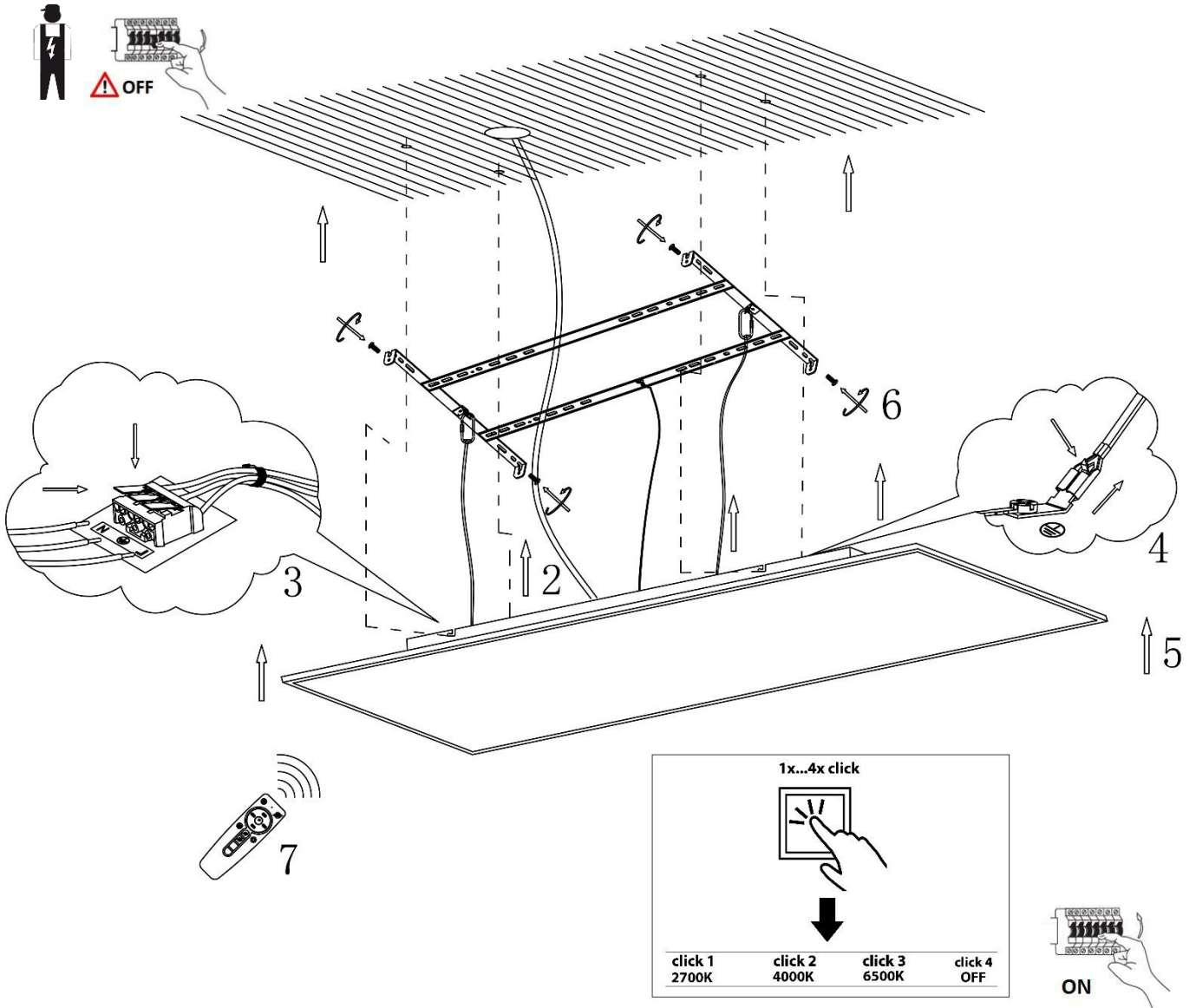

This item contains
unchangeable LED

4400-4600	LM
56	W
2700-6500	K
>80	CRI
20000	H
15000	ON/OFF

60CM

Overall Sizes:

120CM

5.2CM

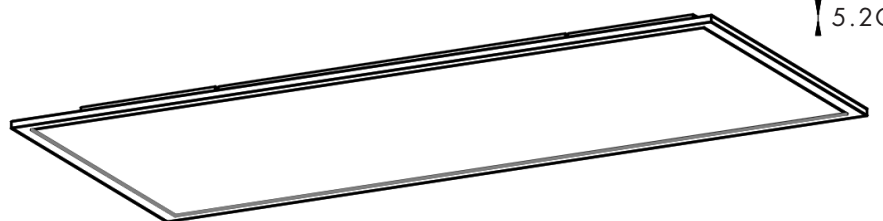

QAZQA

WWW.QAZQA.COM

Remote Control Instruction

15 minutes timing: Turn on the lamp and press the button once. The lamp will flicker once if the setting is successful. Once you set the timing, you can't press the other button or it will cancel the timing mode.

Night Light Mode: Press the button once, the light will switch to warm white night light. Night light cycle is warm white, neutral light, cool white.

Brightness+

CCT-

Neutral light

Warm white

Power on

Power off

Matching Code: Power on the lamp and long press the button within 3 seconds. The lamp will flicker 3 times if the matching is successful.

CCT+

Brightness-

Cold white

50% Brightness: Press the button once, the brightness will decrease to 50%. Then press the button again, the brightness will be 100%.

